

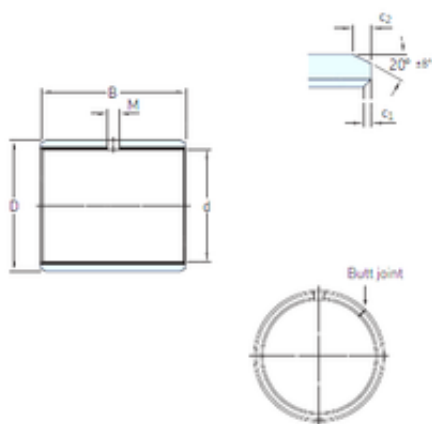

BEARING ITALIA S.P.A

32 mm x 36 mm x 40 mm skf PCM 323640 M
Plain bearings, Bushings



Bearing No. PCM 323640 M

Size	32x36x40 mm
Bore Diameter	32 mm
Outer Diameter	36 mm
Width	40 mm
d	32 mm
D	36 mm
B	40 mm
c1 min	0,1 mm
c2 min	0,8 mm
M	4 mm
Weight	0,057 Kg
Basic dynamic load rating (C)	150 kN
c ₁ min.	0.1 mm
c ₁ max.	0.7 mm
c ₂ min.	0.8 mm
c ₂ max.	1.6 mm
± 8	20 °
Tolerance shaft	h8
Tolerance housing	H7
Basic dynamic load rating - radial direction C	150 kN
Basic static load rating - radial direction C ₀	315 kN
Specific dynamic load factor K	120 N/mm ²
Specific static load factor K ₀	250 N/mm ²

PCM 323640 M Bearing 2D drawings and 3D CAD models



BEARING ITALIA S.P.A

Factor depending on material and bearing type K_M	1900
Permissible sliding velocity v min.	0 m/s
Permissible sliding velocity v max.	2.5 m/s
Coefficient of friction μ min.	0.02
Coefficient of friction μ max.	0.2
Mass bushing	0.057 kg